

PLUS

Copyboard

K-10S/K-10W

Instruction manual

We greatly appreciate your purchase of this PLUS copyboard. In order to take maximum advantage of the functionality of the product, please read this instruction manual carefully before using. Please be sure to keep this manual in a safe place after reading it.

This is a Class A information technology device. Using this device in a home environment may cause radio interference. In this case, the user may be asked to take the appropriate measures to eliminate radio interference.

VCCL-A

About trademarks

- Microsoft and Windows are registered trademarks or trademarks in the United States and other countries of Microsoft Corporation.
- Please note that, even if not indicated specifically, company and product trademarks are fully respected.

Other product and company names included herein are registered trademarks or trademarks of the respective companies.

(Please be sure to observe)

Cleaning

Clean the product as described below to ensure that you always achieve clean prints.

Cleaning the sheet

Wring out a dampen cloth to wipe the surface (If the surface is very dirty, use a cloth with alcohol). Please avoid using the board while the surface is wet. Use a dry cloth for quick drying.

After cleaning, let the sheet dry off completely before using it.

Do not use very dirty erasers, wet wipes, OA cleaners, neutral detergent, etc.

Cleaning the pen tray and frame cover

Use a damp, well wrung cloth to wipe marker dirt off the pen tray and frame cover.

Cleaning the eraser

Using the eraser when it is dirty will make the sheet surface dirty and more difficult to clean. Dedicated eraser replacement sponges are included. Replace the sponge when it is dirty.

Notes on disposal, transfer, exchange and repair

When disposing of this product, please heed local ordinances or regulations.

Main unit accessories

- Dedicated whiteboard marker (black and red, 1 each)

These dedicated markers are used to draw on the sheet surface.

- Dedicated eraser ... 1 (2 replacement sponges)

Use this to erase drawings. The eraser can be used on four sides by turning over the sponge surface. Once all four sides are dirty, mount a replacement sponge.

Contents of the Product's Package

The package contents are as shown below. Please check them before use.

Main unit ... 1 (including printer)

Stand* ... 1 set

This is a mobile stand (with casters) that supports the main unit. For the contents of the stand's package and instructions on assembling it, please see the separate Assembly and Installation Instructions.

AC power adapter (with power cord) ... 1 [UEA360-2425]

This is the power supply adapter for supplying power to the unit.

Note

- The included AC power adapter and AC power cord are exclusively for use with this product. Never use them with other products.

Dedicated thermosensitive paper ... 1 roll

Documents

Instruction manual (this document) ... 1

Safety guide ... 1

Safety Precautions (Please be sure to observe)

Before Using

About pictograms

In this manual, in the Installation and Assembly Instructions and on the product, various pictograms are used to incite proper and safe use of the product and to prevent injury to users and others as well as damage to property. The symbols and their meanings are as shown below. Please be sure to fully understand the meanings of the pictograms before reading the main text.

Warning

This indicates matters that could cause death or serious injury.

Caution

This indicates matters that could cause injury or damage to property.

Meanings of the pictograms

Examples of pictograms

| | | | |
|--|--|--|---|
| | This symbol is used to indicate text calling for caution (including dangers and warnings). A concrete indication of the caution is provided inside the symbol. | | Electrical Hazard |
| | This symbol is used to indicate prohibited acts. A concrete indication of the prohibited act is provided inside the symbol or near it. | | Do Not Disassemble |
| | This symbol is used to indicate instructions or restrictions to actions. A concrete indication of the instruction is provided inside the symbol. | | Unplug the power cord from the wall outlet. |

* For cautions concerning separately sold products, please refer to this manual as well as to the instructions of the sold separately product.

Warning

Do not open or disassemble.
No one other than a qualified serviceperson should open the unit's rear plate. For inspections, adjustments, repairs or cleaning of the interior, please contact your store of purchase.

Keep Water Off
Do not place vases, flower pots, cups, cosmetics, chemicals or containers filled with water on top of the product. Water spilling and getting inside the product could cause fire or electric shock.

Do not place in locations where water is used or where the product could get wet.
If water should get inside the product or if the product should get wet, this could cause fire or electric shock. Avoid using outdoors or near windows when it is raining or snowing.

Do not use if there is a malfunction.
If there is smoke, strange odors or irregular sounds coming from the product, using the product as such could cause fire or electric shock. Immediately turn off the product's power and unplug the AC power adapter from the electrical outlet. Make sure that the product no longer produces smoke, then contact your store of purchase for repairs. Do not try to repair the product yourself. Doing so is dangerous.

Only qualified assembly professionals should install the product.
Faulty installation could lead to the product falling and causing injury.

Wall mounting requires special construction work.
Before installing on a wall, check that the wall surface has sufficient strength to withstand the total weight of the main unit and mounting brackets (as well as earthquakes) over an extended period of time. If the strength is insufficient, please reinforce the wall surface. (Contact your store of purchase concerning this.)

(Please be sure to observe)

Handling of the AC power adapter
• Do not use any AC power adapter other than the one included. Doing so can cause fire or accidents.
• Do not use the included AC power adapter with other equipment or for other applications.

• Do not use the AC power adapter with a voltage other than the one indicated. Doing so can cause fire or electric shock.
• Do not let the AC power adapter get wet. Doing so can cause fire or electric shock.
• Do not subject the AC power adapter to shocks. Doing so can cause fire or electric shock.
• Do not use any power cord other than the one supplied with the included AC power adapter.

Handling of the power cord
A damaged power cord can cause fire or electric shock.
• The included power cord is exclusively for use with this product.
• Do not use it with other equipment or for other applications.
• When installing, be careful that the power cord does not get caught between the product and the wall or rack (shelf), etc.
• Do not modify or damage the power cord.
• Do not place heavy objects on the power cord or pull on it.
• Do not place near heating equipment or otherwise apply heat.
• Do not bend excessively.
• When unplugging the power cord, always hold the plug.
Should the power cord get damaged, contact your store of purchase or a Vision Customer Center for a replacement.

About the AC power adapter's cord and plug

• Do not plug in or unplug the power cord with wet hands. Doing so could cause electric shock.
• Before moving the product, turn off the power and be sure to unplug the power cord from the wall outlet. Moving the product with the power cord plugged in could damage the cord, leading to fire or electric shock.

• Insert the power plug fully into the outlet. Incomplete insertion could cause heating or dust to get on the prongs, leading to fire. Also, touching the prongs could cause electric shock.

• If there is dust near the power plug's prongs or metal objects touching them, unplug the cord and wipe off with a dry cloth. Continuing to use as such could cause fire or electric shock.

If you hear thunder, do not touch the power plug.
If you hear thunder, do not touch the power plug. Doing so could cause electric shock.

Caution

Do not get on top of the product or place heavy objects on it.
Do not get on top of the product. Be particularly careful if small children are present. The product could tip over or break and cause injury.
Do not place heavy objects on top of the product. The product could become unbalanced and fall, causing injury.

Do not hang from the product.
Do not hang from or lean on the product. The product could tip over unexpectedly and cause injury.

Do not install in an unstable location.
If the product is installed on an unstable table or on a slanted surface, it could tip over or fall, causing injury.

Do not lift the product alone.
When lifting the product for installation, etc., the product should be lifted by at least two persons. If you attempt to lift it alone, it could tip over and cause injury.

Names of Parts

Main unit front

About the readable range
The readable portion is the portion indicated in gray on the diagram.

Notice
• It may not be possible to print items written outside of this range.

Locking and unlocking the casters of products with stand

When the unit is moved to a location, use the stoppers to lock the casters after installing. Release the caster stoppers when moving the unit. Press on the bottom of the stopper to lock the caster. Press on the top of the stopper to unlock the caster.

Names of parts

Mounting the stand and changing the height

The following describes how to adjust the height when the stand is mounted. The stand height can be adjusted 3 steps, in units of 100 mm.

• The main unit should be held by at least two persons. If not, it could drop or tip over unexpectedly, resulting in injury.
• Press the bottom side of the stoppers on the stand's casters to lock the casters. If not, the stand could move unexpectedly when removing or mounting the main unit, resulting in injury.
• When changing the height of the main unit, unplug the power cord from the wall power outlet and disconnect all of the main unit's input and output terminals. Removing the main unit with the cords still connected could cause the stand to tip over unexpectedly, resulting in injury.
• When changing the height of the main unit, be careful not to bang the main unit, particularly the printer section.

- Unplug the power cord from the wall power outlet, then disconnect the AC power adapter.
- Remove the locking knobs (one each on the left and right sides).
- Move to different holes in the main unit's support brackets.
The main unit is released from the hooks when it is lifted about 1 cm.
Catch the stand's hooks fully into the mounting holes (one each on the left and right sides) in the main unit's support brackets.
- Mount one locking knob each on the left and right sides and tighten them onto the support brackets.
* Tighten the knobs securely, making sure there is no looseness.
- Attach the AC power adapter.

Attaching the AC power adapter

- Insert the AC power adapter into the AC power adapter holder with the DC plug side facing up. When doing this, also insert the AC power cord.
- Insert the DC plug all the way into the DC input terminal located on the printer's rear panel.
- Insert the AC power cord into the cable cover on the stand.
* When using the copyboard, plug the AC power cord into a wall outlet.

(Please be sure to observe)

Handling of the stand (optional stand)
To prevent tipping, pay attention to the points below. Failure to do so could cause injury or malfunction.

- Use on a flat floor.
- Lock the casters when installing and using. When moving, unlock the casters, support both sides of the unit and move gently, avoiding shocks.
- When lifting the product to adjust its height, etc., the product should be lifted by at least two persons. If you attempt to lift it alone, it could tip over and cause injury.
- Do not lean on the product or apply unnecessary force to the top.

Unplug the power cord when not using.
When not using the product for extended periods of time, unplug the AC power adapter's power plug from the electrical outlet. Leaving it plugged in could lead to fire due to short-circuit.

About light reflected off the sheet
• Do not use the sheet surface as a screen for a projector. The projector's reflected light could cause eye fatigue or other symptoms.
• Reflecting a laser pointer on the sheet surface could lead to unexpected accidents. Avoid using laser pointers.

About the place of installation
• Do not place in hot locations, such as places exposed to direct sunlight, or in places exposed to the direct wind from air conditioners.

• Do not place in locations exposed to soot or humidity (such as near cooking ranges or humidifiers).

• Install the product near a wall power outlet.

• Install in a place where the wall outlet is easily accessible for unplugging the power cord.

If you hear thunder, do not touch the power plug.
If you hear thunder, do not touch the power plug. Doing so could cause electric shock.

Notes

Do not use lining tape or the like.

If lining tape is left attached to the sheet for long periods of time, it may be difficult to peel it off neatly. Also, the tape could peel off when the sheet is moved, causing malfunction.

Do not attach paper, etc., to the sheet.

Do not attach film-like objects or paper to the sheet and print on it. Doing so could cause malfunction. Use template sheets designed specifically for this product. For more information, please contact your store of purchase.

Do not damage the sheet surface.

Do not tap or poke the surface of the sheet with sharp or hard objects.

Do not get the seams dirty.

Be careful not to let the sheet's seams get dirty. The dirt could appear in the prints.

Do not wipe the sheet with chemicals.

Do not wipe the main body or sheet with thinner, benzene, etc. Doing so could cause discoloration or damage the sheet.

Use dedicated markers.

Always use the dedicated markers and erasers. Using other markers or erasers or rubbing the sheet by hand could damage the sheet and get the sheet dirty, and you may not be able to remove the ink. Always store the markers horizontally. If not, it may be difficult to remove the ink.

Do not leave writing on the sheet for long periods of time.

It may be difficult to remove the ink.

Write within the readable range.

Items written outside of the range may not be printed.

About moving the sheet

- Do not to move the sheet with magnets stuck on it. In rare cases, the magnet could get caught in the product and cause malfunction. In addition, do not use sheet type magnets.
- Moving the sheet suddenly could damage the product's drive section. Please move the sheet slowly.
- Do not move the sheet with sticky notes attached to it. Doing so could cause malfunction.

Names of parts

Operating parts common to all models

| | |
|-----------------------------------|--|
| A : Open button | When this button is pressed, the printer hatch opens. Press this to replace the recording paper. |
| B : POWER key | This turns the power supply on and off. |
| C : POWER ON lamp | This lamp lights (green) when the power is turned on, and turns off when the power is turned off. |
| D : STATUS lamp | This indicates the unit's operating status or error status. The lamp flashes green when the unit is operating. |
| G : Additional print key (REPEAT) | Use this key to make additional prints. The sheet does not move when this key is pressed. |
| H : Sheet FEED/STOP key | Use this key to move the sheet to the left. When the key is pressed again while the sheet is moving, the sheet stops moving immediately. Use this to stop reading before printing. |

K-10S operating panel

| | |
|------------------------------------|---|
| E : Print key | Use this to print one sheet's worth of data in A4 size. The aspect ratio of the data on the sheet is maintained. |
| F : Two-sheet compressed print key | Use this to compress two sheet's worth of data and print it in A4 size. The data on the two sheets is compressed in the horizontal direction. |

K-10W operating panel

| | |
|--------------------------------|--|
| E : Compressed print key | Use this to compress one sheet's worth of data and print it in A4 size (210 × 297 mm). The data is compressed in the horizontal direction. |
| F : A4-L equal ratio print key | Use this to print one sheet's worth of data in A4 L size (210 × 405mm). The aspect ratio of the data on the sheet is maintained. |

Usage

Before Using

Loading the recording paper

- Press the open button to open the printer hatch.

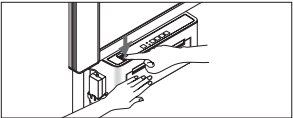

- To replace the recording paper, remove the spent recording paper's core.

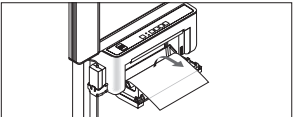

- As shown on the diagram, unroll about 20 cm of the end of the new roll of recording paper and set it with the heat-sensitive surface facing upward.

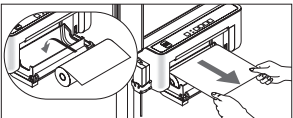

- Press both ends of the printer hatch and close it until it locks with a click. Check at this time that the recording paper has not slipped.

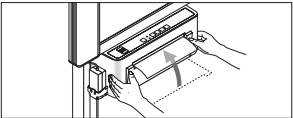

- Cut off the extra recording paper protruding from the printer's outlet.

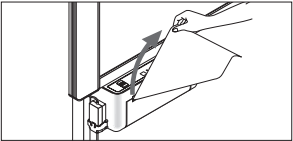

Turning on the power

- Connect the power cord's AC power plug to an electrical outlet.
- When you press the [POWER] key, the power turns on, the POWER ON lamp flashes orange, then switches to green and stops flashing after about 10 seconds.

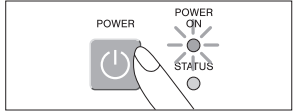

Reading adjustment (white calibration)

If fine lines in the horizontal direction or thick black bands are printed, the sheet surface reading sensitivity must be adjusted to the optimal setting.

If there are problems with image reading, be sure to perform white calibration using the procedure below.

Preparations

- Carefully clean a strip 20 cm wide along the left edge of the sheet using the included whiteboard cleaner or a damp cloth. Avoid joints in the sheet, as correct adjustment is not possible if there are joints in this cleaned band.

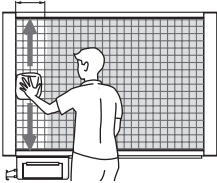

- Move the sheet by hand so that about half of the cleaned band is hidden by the main unit's frame cover.

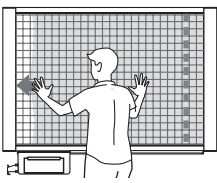

Operation

- Check that the main unit's power is on.

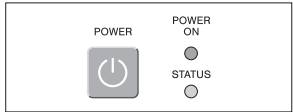

- Press the [FEED/STOP] key while pressing the [COPY] (K-10W: [COPY-A4]) key. The POWER ON lamp starts flashing green.

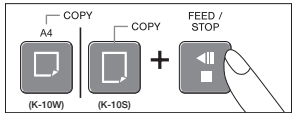

- Press the [COPY] key. The STATUS lamp flashes green and calibration is performed.

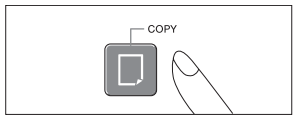

- Calibration is completed when the STATUS lamp stops flashing, remaining lit green. Press the [FEED/STOP] key.



Usage

Printing

- To print 1 sheet (K-10S)
Press the print key.
The sheet moves one frame and the contents written on it are printed in A4 size. The aspect ratio of the data on the sheet is maintained.

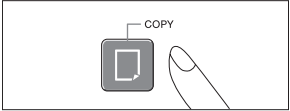

- For two-sheet compressed printing (K-10S)
Press the two-sheet compressed print key.
The sheet moves two frames and the contents written on it are compressed and printed in A4 size. The data is compressed in the horizontal direction.

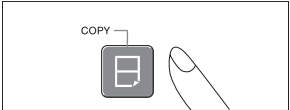

- For A4 compressed printing (K-10W)
Press the compressed print key. The sheet moves one frame and the contents written on it are compressed and printed in A4 size. The data is compressed in the horizontal direction.

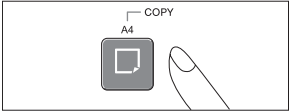

- For A4-L equal ratio printing (K-10W)
Press the type L equal ratio print key. The sheet moves one frame and the contents written on it are printed in A4-L size (210 x 405 mm).

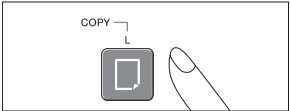

- For an additional print
Press the [REPEAT] key.
The contents that were printed just before are printed again. The sheet does not move when this key is pressed. This does not work if nothing has been printed since the POWER key was pressed to turn the power on.

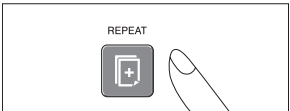

- Stopping the printing operation
Press the [FEED/STOP] key.

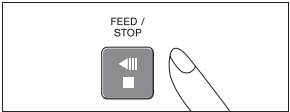

- Cutting the recording paper
Once the printing process is finished, pull the leading edge of the recording paper upward and cut it along the edge of the outlet.

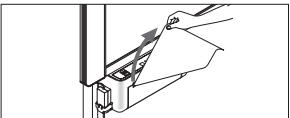

Usage

Moving the sheet

- Moving with the key
Press the [FEED/STOP] key. When the key is pressed, the sheet moves to the left by one frame then stops. When the [FEED/STOP] key is pressed while the sheet is moving, the sheet stops.



- Moving by hand
The sheet can also be moved by hand. In this case, it can be moved to either the left or the right. Note that moving the sheet too quickly can cause malfunction. Do not move the sheet too quickly.

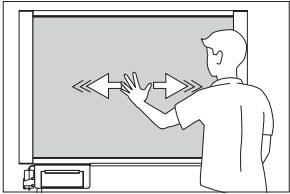

Device settings (via USB)

- Turn on the unit's power and connect the USB port (Type B) and computer by USB cable.

- The standard drivers are installed automatically, and the unit is recognized by the computer as a removable device.

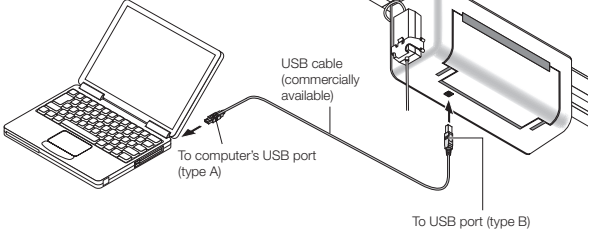

* Use a commercially available A-B type USB cable.

- Launch Windows Explorer and open the removable device (this unit).

Double-click on the removable device (this unit, displayed as "K-10") to open it.

- Open the "setting.ini" file in the "setup" folder using the computer's Notepad application, etc.

- Double-click the setup folder to open it.
- Open the "setting.ini" file (text format) located in this folder using the computer's Notepad application, etc., and rewrite the contents of the settings file directly.

* Only single-byte numbers, the slash, colon, and equal signs can be entered. Do not use any spaces.

* There is no function to save scan data to the computer via USB.

Usage

Contents of the "setting.ini" file

```
Version = 04.00
A4 Page = 1
-----
Date = 2016/11/14
Time = 15:57:19
Format = 0
DatePrint = 1
Density = 1
```

| Item | Item name | Setting value | Initial setting |
|--------------------------|-----------|---|----------------------------------|
| Time setting | Date | (Example) Input in the following format: 2016/08/24 09:13:00 | Time currently set for the board |
| | Time | | |
| Date format | Format | 0 = YYYY/M/D 1 = DD-MMM-YYYY 2 = MMM-DD-YYYY | YYYY/M/D |
| Print date | DatePrint | 0 = No 1 = Yes | Yes |
| Print density adjustment | Density | 0 = Thin 1 = Normal 2 = Darker | Normal |

- Save (overwrite) the "setting.ini" settings file.

Destination: This unit's (the removable device's) "setup" folder

File name: setting.ini

* To check the settings, reconnect the USB cable then open the "setting.ini" file again.

Replacing the recording paper

In the cases described below, follow the procedure under "Loading the recording paper" in the "Before Using" section to replace the recording paper with new recording paper.

- When a red line appears along the edge of the recording paper. (This red line appears when the amount of recording paper remaining is about 1 meter.)
- When the status lamp lights (indicating there is no paper).



- Nothing will be printed if the paper is loaded with the recording surface set in the wrong direction. Be careful to load the recording paper in the proper direction.
- If the recording paper has slipped to either the left or right, the printing position may be off and the recording paper may get wrinkled. If this happens, reload the recording paper.

Simple Troubleshooting

STATUS lamp description

| Status | Please check. |
|--|---|
| STATUS lamp is lit orange | → The printer is out of paper. Load recording paper. → Close the printer hatch properly. |
| STATUS lamp is flashing orange | → The temperature of the printer is too high. Unplug the power cord and refrain from using until the temperature decreases. |
| STATUS lamp is lit red or flashing red | → The copyboard is malfunctioning. Contact your store of purchase. |

Before asking for repairs

| Status | Please check. |
|--|---|
| POWER ON lamp does not light when power is turned on | → Check that the power cord is plugged into a power outlet. |
| Nothing is printed when print key is pressed (recording paper does not come out) | <ul style="list-style-type: none">The paper is jammed inside. → If the paper is jammed, remove the jammed paper. <ul style="list-style-type: none">The printer hatch is slightly open. → Close the printer hatch tightly until you hear a click. |
| Printer is operating but nothing is printed on recording paper | <ul style="list-style-type: none">The recording paper is loaded in the wrong direction. → Load the recording paper in the proper direction (with the smooth surface facing up). |
| Print on the recording paper is thin or patchy | <ul style="list-style-type: none">The lines written on the white sheet surface are too fine or too thin. → Either write with thick, dark lines or use a new marker. <ul style="list-style-type: none">Problems related to the usage environment → Use the procedure under "Print density adjustment" in the device settings to make the print denser. |
| Black horizontal lines appear on recording paper | <ul style="list-style-type: none">Faulty reading (dark lines) → Perform the reading adjustment (white calibration) procedure. <ul style="list-style-type: none">The ruled lines are also being read. → Use the procedure under "Print density adjustment" in the device settings to make the print thinner. |
| Eraser does not erase writing on sheet | <ul style="list-style-type: none">Are you using a marker other than a dedicated marker? → Apply some water to a cloth and wring out thoroughly (for tough dirt, apply some alcohol to the cloth), then carefully wipe the sheet clean. Always use a designated marker. |
| Print is dirty | <ul style="list-style-type: none">Is there a lot of marker residue on the sheet? → If the sheet is dirty, apply some water to a soft cloth, wring out thoroughly, then wipe the sheet with gentle strokes. <ul style="list-style-type: none">The paper feed roller (black rubber roller) is dirty. → Open the printer hatch and wipe the dirt off the paper feed roller. |

* If the problem persists after doing the above, contact your store of purchase.

Dedicated expendables

- Board marker - black: MARKER-BK Black [423-283]
- Board marker - red: MARKER-RD Red [423-284]
- Eraser: ER-44369 [44-369]

Specifications

| Model name | | K-10S | K-10W |
|----------------------|---|--|---|
| Exterior | External dimensions | W1480 × D675 × H1847 | W1980 × D675 × H1847 |
| | Weight | 31.5 kg | 35.5 kg |
| Board | Board surface dimensions | W1300 × H910 | W1800 × H910 |
| | Effective reading dimensions | W1280 × H900 | W1780 × H900 |
| | No. of board surfaces | 2 | |
| | Sheet feeding | Unidirectional, endless (horizontal scrolling) | |
| | Drive system | Sheet moving method | |
| | Reading method | CIS (Contact Image Sensor) | |
| | Reading illumination light source | RGB LED | |
| | Reading resolution | 1.92 dots/mm | |
| | Reading and printing time (* Print time will vary according to the amount of data.) | 1-sheet printing: Approx. 10 seconds reading, approx. 11 seconds printing 2-sheet printing: Approx. 20 seconds reading, approx. 22 seconds printing | A4 compressed printing: Approx. 14 seconds reading, approx. 15 seconds printing A4-L equal ratio printing: Approx. 14 seconds reading, approx. 15 seconds printing |
| | Recording method | Thermal head thermosensitive recording | |
| Printer | Recording size | 1 sheet (A4 equal ratio), 2 sheets compressed (A4 compression) A4 size (W210 × H297 mm) | 1 sheet (A4 compression, A4-L equal ratio) A4 size (W210 × H297 mm) A4-L-size (W210 × H405 mm) |
| | Recording paper size | | |
| | Recording color | Monochrome | |
| | Print resolution | 200 dpi | |
| Additional functions | No. sheets printed | 1 sheet | |
| | Clock | Used for time stamps | |
| | Computer connection | Device settings | |
| | AC power adapter | Input: AC 100-240 V, 50/60 Hz, 1.5 A Output: DC 24 V, 2.5 A | |
| Power supply | Power consumption | In power-saving mode: 1W, Operating: 50W | |
| | Temperature | 10°C-35°C | |
| Usage conditions | Humidity | 30 to 85% (with no condensation) | |
| | | | |
| Others | Ruled lines | 50 mm grid | |
| | Writing tool | White board markers (black and red) | |
| Functions | Equal ratio printing | ○ | ○ |
| | 2-sheet printing | ○ | — |
| | Recording density adjustment | 3 levels of adjustment in the device settings | |
| | Manual board surface moving function | ○ | ○ |
| | Accessories | Dedicated white board markers (black and red), dedicated eraser, 2 eraser replacement sponges, dedicated thermosensitive paper (30 m roll), AC power adapter (with 2.5 m power cord), instruction manual | |

* Please note that product specifications and appearance are subject to change without notice.