

DIGITAL PEN ADP-301

User’s Guide

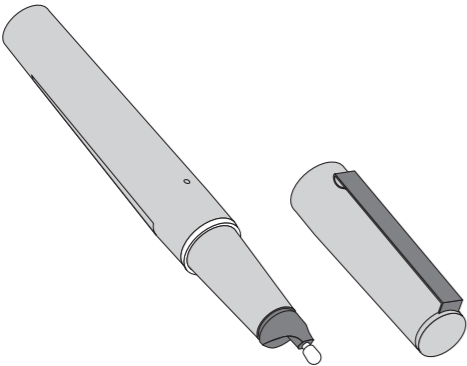

Thank you for your interest in the Digital Pen.

Reading and frequently referencing to this user manual will help you get the most out of using the digital pen.

The information contained in this manual may be necessary when using the digital pen.

Please keep this user’s guide in an easily accessible place and read through the complete document before the digital pen is used.

Operating environment

The environment and equipment described below is required to use this product.

- Computer on which Bluetooth is operational
(Computer with built-in Bluetooth or using a commercially available Bluetooth USB adapter)
- UPIC Wireless Interactive Panel or UPIC Notepad

NOTE

This product is supported by UPIC software Ver. 3.0 and later.
* If you are using an older version of the software, download the latest version from the PLUS website.

NOTICE

When registering an old type of digital pen at the same time, be sure to update the UPIC software to the latest version.
* Some functions differ according to the digital pens that are added.

! WARNING

[Digital pen, Battery]

Do not use in hot places.

- Do not use or leave in places where the temperature is high (near fires or heaters, in the sun, etc.) or in places where flammable gases may be generated. Doing so could result in ignition, explosion, malfunction or fire.
- Do not place in microwave ovens, high pressure containers, etc. Doing so could result in ignition, explosion, malfunction or fire.
- Do not dispose of in flames or heat. Doing so could result in ignition, explosion or fire.

Keep away from the eyes.

Battery fluid getting into the eyes could result in blindness or visual impairments. If any battery fluid should get in your eyes, flush with large amounts of tap water, etc., without rubbing, then contact a physician immediately for treatment.

[Digital pen]

Do not point the pen at your eyes.

Do not point the digital pen at your eyes. Peering directly into the pen’s infrared rays could result in visual impairments.

Do not subject to strong shocks.

Do not drop the digital pen, throw it against hard objects or otherwise subject it to strong shocks. Doing so could cause breakage, overheating, fire or malfunctions.

[Digital pen, Battery]

Do not use if there is an abnormality.

If there is smoke or a strange smell coming from the digital pen or the pen is otherwise abnormal, remove the battery immediately. Continued use could result in fire or electric shock.

Do not disassemble or modify.

Disassembling or modifying the digital pen could result in fire or electric shock. There are dangerous high pressure parts inside the digital pen. Never try to fix it yourself; doing so is dangerous.

Keep away from water or other liquids.

Water or oil inside the digital pen could result in electric shock or malfunction. Never use the digital pen in places directly exposed to water; etc., in bathrooms or other humid places, etc., or touch it with wet hands. Doing so could result in electric shock or malfunction due to short-circuiting of the electronic circuitry or corrosion. Be careful when using in the rain or snow, on the seashore, near water; etc. If the digital pen should get wet, contact your store of purchase or a PLUS inquiry center for inspection (for a charge).

Do not let any foreign substances get inside.

Do not put water, metallic objects or easily burnable materials inside. Doing so could result in fire or electric shock. If a foreign substance should get inside, discontinue use immediately and remove the battery.

[Battery]

Do not charge or disassemble.

Do not charge, overheat or disassemble the battery.

Do not short-circuit or disassemble batteries or dispose of them in flames.

[Others]

Do not use in airplanes.

Do not use the digital pen in airplanes, as doing so could interfere with safe operation of the aircraft. (Be sure to put on the cap to turn off the power before boarding the plane.)

Do not use near high precision electronic equipment.

Turn off the power near high precision electronic equipment. The digital pen could affect electronic equipment. (Examples of electronic equipment that could be affected: pacemakers, hearing aids, other electronic medical equipment, fire detectors, automatic doors. If you use any electronic medical equipment, contact the equipment’s manufacturer or your store of purchase to inquire about the effect of radio waves.)

! CAUTION

[Digital pen]

Do not point the lens at sunlight.

Leaving the digital pen with the lens pointing into the sunlight could damage it.

[Battery]

When not planning to use for long periods of time, remove the battery from the battery case. If the battery is left in the battery case for long periods of time without using the digital pen, fluid could leak from the battery, damaging the digital pen.

When inserting batteries, be sure to do so with the proper polarities (“+” and “-” direction), following the marks in the case.

[Others]

Keep out of the reach of children.

Store the digital pen in a place where no child risks accidentally swallowing or getting poked in the eye by the digital pen’s cap or stylus. If a child should swallow or be injured by the cap or stylus, contact a physician immediately.

Additional Cautions

Do not wipe the digital pen with benzene or thinner.

Doing so could mar the case or cause the paint to peel off.

Keep away from sand and dust.

The pen may be damaged if fine sand or dust should get inside.

Do not use in the places described below.

- Using near TVs or radios may cause noise on the TV screen or in the sound of the radio.
- The digital pen may not operate properly when used in places exposed to strong radio waves or magnetic forces, such as near radio towers or electric equipment that includes motors.
- Using in places exposed to the exhaust gases of gasoline or diesel engines or to such corrosive gases as hydrogen sulfide may corrode internal parts, leading to malfunction.
- Do not use near humidifiers. Depending on the properties of the water in the humidifier, calcium or other elements scattered in the air could cause a film of white powder to form on the lens, preventing proper function of the digital pen. The humidity could also get inside the digital pen and cause condensation, preventing proper function of the digital pen.
- The digital pen may not function properly if used in extremely hot or cold places.
- The digital pen may be damaged if left for an extended period of time in a closed up car.
- Do not use in sooty, humid places. Doing so could deform the digital pen’s case and result in malfunction.

Use an AAA alkaline battery.

Cautions on storing

Take care that small children do not accidentally swallow the cap, stylus or battery.

If an infant or child should swallow one of these parts, contact a physician immediately.

Do not put in places exposed to strong magnetic forces or vibrations.

Do not put in places exposed to strong magnetic forces or vibrations. Doing so can result in malfunction.

Always put on the cap when not using.

Putting on the cap turns the digital pen’s power off. This keeps the battery from wearing down and protects the inside from dust.

Contact address

PLUS Corporation

Manufacturer

Anoto Group AB

How to switch on and off the digital pen

Switch on the digital pen by taking off the cap.

Switch off the pen by putting on the cap.

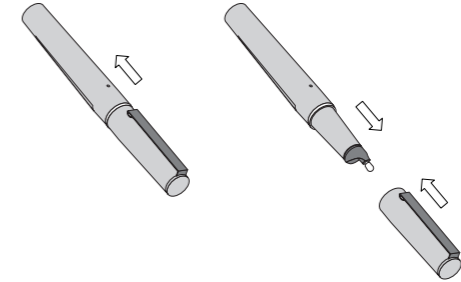

How to insert or remove the battery

- Put the cap on the pen and wait 10 seconds for the pen to switch off.
- Slide the lock lever as shown in the picture, and open the battery cover:

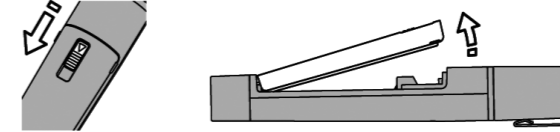

- Remove battery if applicable

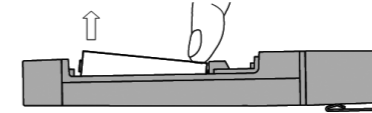

- Adjust to the polarity indication of the holder (+, -) and insert the battery correctly.

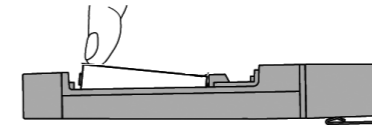
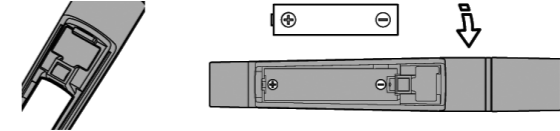

- Close the cover, and slide the lock lever:

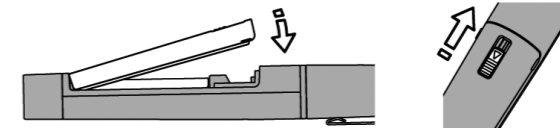

Replacing the stylus

If the stylus should wear down or get bent, replace it with the included spare stylus.

- Grasp the stylus (the round pen tip) and pull it straight off.

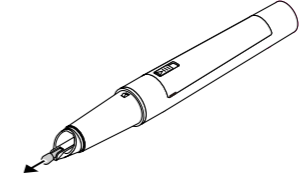

- Insert the new included spare stylus straight onto the pen tip until it stops.

* There are two types of styluses, one for UPIC Wireless Interactive Panel, one for UPIC Notepad.

With the UPIC Notepad stylus, the stylus is inserted with the stopper facing upward.

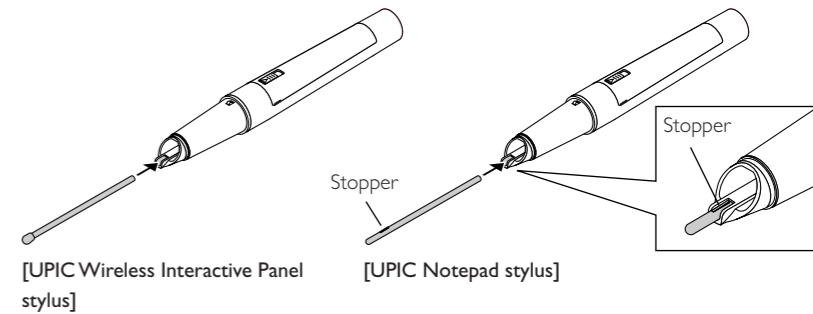

How to hold the digital pen

Do not cover the nib with the fingers

The digital pen takes snapshots of the paper to find out where on the paper you write.

Therefore, do not cover the nib with your fingers when writing.

Do not push the switch with your fingers.

The pen switches off when the cap is put on the digital pen.



Do not push the switch with your fingers when you hold the pen as shown in the figure. If the switch is pushed a few seconds the pen turns off.

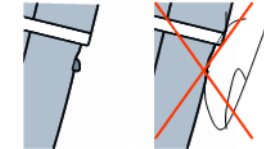

LED indication during use

The LED on the digital pen will give you feedback during use.

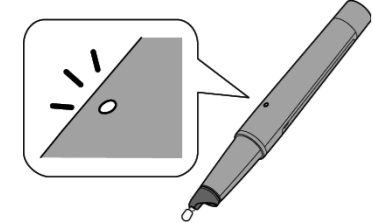

Pen status	LED indication	Comment
Low battery	Warning	The LED flashes for 2 seconds in 15-second cycles. Replace the battery as soon as possible.
Bluetooth connecting	Slow pulse	Standby in the pairing mode
Bluetooth connected	Lit	The LED lights for 3 seconds, then turns off.
Battery spent	Warning	The pen's power turns off after 8 seconds. Replace the battery.

Explanation of LED indication:

- Warning: 0.2 sec on / 0.2 sec off pulses
- Slow pulse: 0.2 sec on / 3 sec off

If the pen, with the cap off, hasn't been used during an about 7 minutes period it will automatically switch off.To switch it on put on the cap and take it off again.

Technical data

Model	ADP-301
Weight	40 g (with battery) 31 g (without battery)
Dimensions	159.5 × 20.5 × Ø18.5 mm (with cap)
Data communication	Bluetooth 2.0, HID
Operating temperature	0 to 40°C (no condensation)
Storage temperature	−20 to +65°C (no condensation, no battery, no refill)
Dry Cell	AAA-type 1.5V Alkaline battery
Continual operation time	6 hours or longer (Normal Temperature 25°C±2°C)
Battery standby time	150 hours (without a cap)
Bluetooth passkey	0000

FCC warning

Changes or modifications not expressly approved by the party responsible for compliance could void the user's authority to operate the equipment.

Notice

This equipment has been tested and found to comply with the limits for a class B digital device, pursuant to peat 15 of the FCC Rules.These limits are designed to provide reasonable protection against harmful interference in a residential installation.

This equipment generates, uses and can radiate radio frequency energy and, if not installed and used in accordance with the instructions, may cause harmful interference to radio communications. However, there is no guarantee that interference will not occur in a particular installation.If this equipment does cause harmful interference to radio or television reception, which can be determined by turning the equipment off and on, the user is encouraged to try to correct the interference by one or more of the following measures:

- Reorient or relocate the receiving antenna.
- Increase the separation between the equipment and receiver.
- Connect the equipment into an outlet on a circuit different from that to which the receiver is connected.
- Consult the dealer or an experienced radio /TV technician for help.

This device complies with Part 15 of FCC Rules and RSS-Gen of IC Rules. Operation is subject to the following two conditions: (1) this device may not cause interference, and (2) this device must accept any interference, including interference that may cause undesired operation of this device.
<ul style="list-style-type: none">This class B digital apparatus complies with Canadian ICES-003.Cet appareil numérique de la classe B est conforme à la norme NMB-003 du Canada.
About the RF Exposure <ul style="list-style-type: none">This transmitter must not be co-located or operated in conjunction with any other antenna or transmitter.This equipment complies with FCC / IC radiation exposure limits set forth for uncontrolled equipment and meets the FCC radio frequency (RF) Exposure Guidelines in Supplement C to OET65 and RSS-102 of the IC radio frequency (RF) Exposure rules.This equipment has very low levels of RF energy that it is deemed to comply without testing of specific absorption ratio (SAR).

Declaration of conformity

Digital Pen Model ADP-301

to which this declaration relates is in conformity with the following standards

- EN60950-1, 2001 (Safety), - EN55022:1998 Class B (EMI), - EN55024:1998 (EMS)
- EN301 489-17 V1.2.1:2002, EN301 489-1 V1.4.1:2002 (EMC)
- EN300 328-2 V1.6.1:2004 (EMI)

Following the provision of R&TTE Directive 1999/5/EC

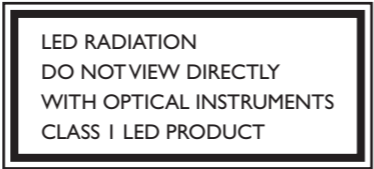

Disposal of Waste Equipment by Users in Private Household in the European Union

(Applicable in the European Union and other European countries with collection systems)





Note:This symbol mark is for EU countries only.
This symbol mark is according to the directive 2006/66/EC Article 20
Information for end-users and Annex II.

This symbol means that batteries and accumulators, at their end-of-life, should be disposed of separately from your household waste.

Bluetooth Information

The Bluetooth Qualification information of this product could be referred to Bluetooth identifier B013766.

Trademark Notices

- “Anoto”, *Anoto* and  are trademarks owned by Anoto AB, Sweden.
- “Bluetooth” and  **Bluetooth**® are the trademarks of Bluetooth SIG, Inc.
- All company names, brand names and product names are trademark or registered trademark of each company.

Australia

Add the text and label below.



Korea

무선기기로서의 주의

본 제품은 무선통신 기능이 있으며 전파 법에 따라 소전력 데이터 송신시스템무선설비로서 인증을 받았습니다.

따라서 본 제품을 한국 국내에서 사용할 경우에는 무선국의 면허는 필요 없습니다.

단, 이하의 행위는 법률상 금지되어 있습니다.

- 본 제품을 개조/분해하는 것.
- 본 제품에 붙어 있는 라벨(증명 라벨)을 떼어 내는 것.

- 기기의 명칭 : 무선 데이터 통신시스템용 무선기기
- 모델명 : DP-301
- 인증 번호 : AGR-DP-301

당해 무선설비는 운용 중 전파혼신 가능성이 있음

기종별	사용자 안내문
B급 기기 (가정용)	이 기기는 가정용으로 전자파적합등록을 한 기기로서 주거지역에 서는 물 론 모든 지역 에서 사용할 수 있습니다.

※당해 무선설비는 전파혼신 가능성이 있으므로 인명안전과 관련된 서비스는 할 수 없습니다.

Bluetooth기기로서의 주의

본 제품은 Bluetooth기기로서의 로고 인증을 받았습니다.

본 제품의 인증정보에 대해서는 Bluetooth ID 번호B013766을 참고해 주시기 바랍니다.

(The Bluetooth Qualification information of this product could be referred to Bluetooth identifier B013766.)

Singapore

It is recommended to add the approval number:

Approval: S1913-09
Issued: 08 October 2009

Malaysia

It is recommended to add the approval number:

Approval: RAHY/29D/0809/S(09-1607)
Issued: Aug 13, 2009

